

1

2

3

4

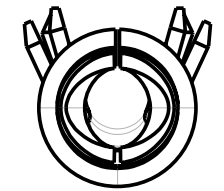
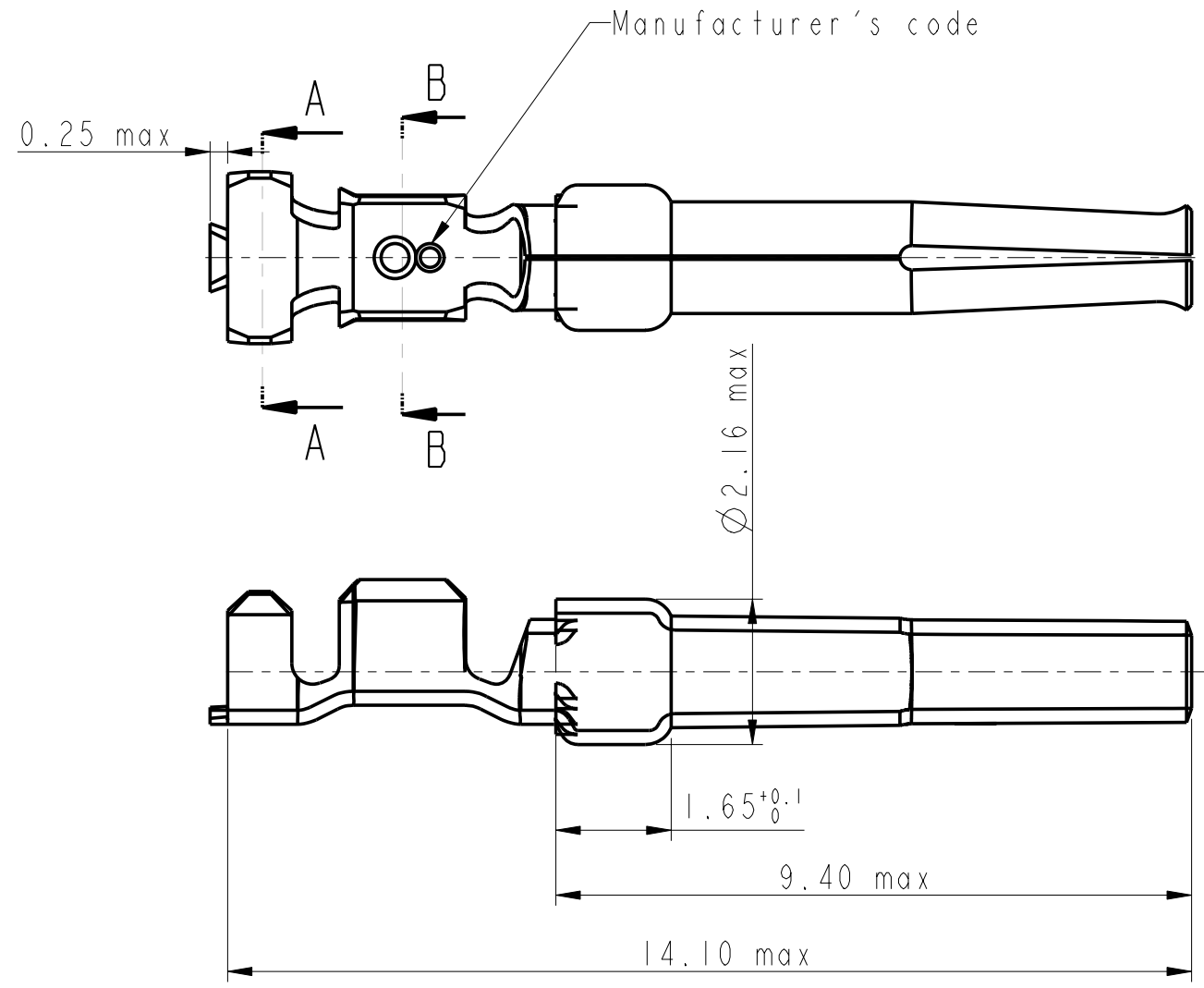

NOTES:

- 1-Material:phosphor bronze,thickness 0.20
- 2-Finish on contact area:see table  
finish on termination:bright tin lead over nickel
- 3-Wire range:20 to 24 AWG
- 4-Max outer dia of wire insulator:1.73 mm
- 5-Current carrying capacity per contact:
  - 5.Amps max when crimped to #20 AWG
  - 5 Amps max when crimped to #22 AWG
  - 3 Amps max when crimped to #24 AWG
- 6-After 5 insertions into connector,  
contact retention must be 5 pounds axial load min
- 7-When contact is crimped to 20 AWG,the insulation  
support crimped height must be 1.78 mm max to ensure  
a proper insertion into housing
- 6-Packaging:Reel of 5000 contacts

NOTE : ROHS INFORMATIONS

The LF products meet European union directives and other country regulations as described in GS-22-008  
Terminations plating spec : 2um Nickel min + 2um Sn min  
Packaging Spec : see GS-14-930

CORE RANGE	
86566520067LF	0.4μ Au
86566520067	0.4μ Au
86566520065LF	0.76μ Au
86566520065	0.76μ Au
86566520064LF	Flash Au
86566520064	Flash Au
PART NUMBER	Plating

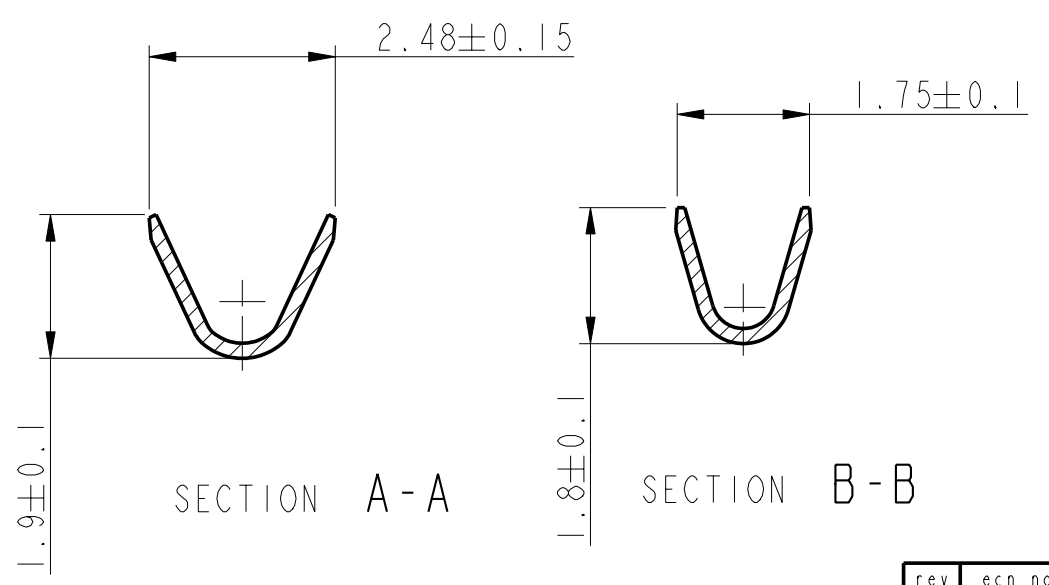

www.fciconnect.com		surface - ✓ ISO 1302	tolerance std ISO 406 ISO 1101	projection mm
TOLERANCES UNLESS OTHERWISE SPECIFIED				
Dr	C JARRY	28/01/97	ANGULAR	size A3
Eng			LINEAR	Scale 10:1
Chr			0° ±2°	ECN LS06-196
Appr			Product family	Spec ref

rev	ecn no	dr	date
E	LS06-196	MPE	28/11/2006
-	-	-	-
-	-	-	-
-	-	-	-
-	-	-	-
-	-	-	-

**FCi** CRIMP SOCKET  
# Wire 20-24 Ø1.52 MAX

dwg no C01-8656-0424

Rev. E

CUSTOMER STATUS: Released

sheet 1 of 1

Copyright FCI.